

## **No more loose toilet seats**

### **SolidFix – a steadfast interlock to face the difficulties of your daily project life**

How doesn't know this annoying problem: the toilet seat is loose or slips, because the fixations become loose.

At Hamberger Sanitary, the tried-and-test FastFix fitting has offered the solution for a firm, durable fit and quick mounting for many years. Entirely new in the range is now the innovative SolidFix fitting, which guarantees a steadfast interlock for use in public toilets in particular. The trick: the stainless steel hinge is fastened onto the ceramic thanks to the prestressed washers with the additional curved sealing ring. By using the stainless steel bolt and the enclosed fastening screw, the hinges are easily and permanently fastened to the ceramic – no slipping or loose toilet seats anymore. The oval shape of the washer and sealing ring allows an ideal adjustment to the various ceramic types. To facilitate mounting, they were designed in such a way that they, once slid onto the screw, no longer fall off. SolidFix can be removed any time without any traces, as the overlapping plastic sealing ring protects the ceramic from scratches. The new fastening solution is available in all HARO Careline models. SolidFix – permanently satisfied customers in project business.

---

#### **Contact and image details:**

Hamberger Sanitary GmbH,  
Pressestelle, Michaela Beiel, Postfach 10 03 53, 83003 Rosenheim  
Telephone +49 (0) 8031 700-648, fax +49 (0) 8031 700-660, e-mail: m.beiel@hamberger.de

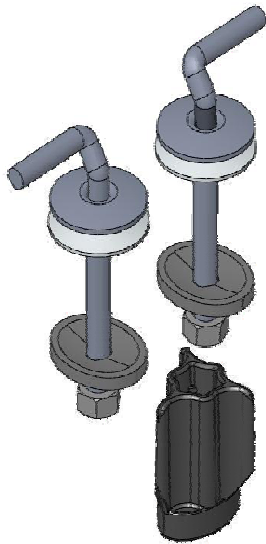

## SOLID FIX®

The SolidFix fastening on the HARO hinge B0302

Photograph: Hamberger Sanitary

May be reprinted free of charge.  
Please provide a specimen copy.

Hamberger Sanitary GmbH based in Rohrdorf near Rosenheim is now the largest manufacturer of toilet seats in Europe and operates production sites in Germany and Bulgaria. Hamberger has been manufacturing toilet seats since 1912. The fact that the company develops its own designs, uses its own established hinge technology and operates a global logistics network forms the basis for its success. The company was established back in 1866 and is now managed in the fourth and fifth generation by Peter Hamberger and his son Dr Peter Hamberger. The company has constantly acquired new shares of the market and is now the largest manufacturer of duroplast toilet seats anywhere in the world. Around 50% of its products are exported to more than 50 different countries throughout the world. Further information is available at [www.hamberger-sanitary.de](http://www.hamberger-sanitary.de)

---

### Contact and image details:

Hamberger Sanitary GmbH,  
Pressestelle, Michaela Beiel, Postfach 10 03 53, 83003 Rosenheim  
Telephone +49 (0) 8031 700-648, fax +49 (0) 8031 700-660, e-mail: [m.beiel@hamberger.de](mailto:m.beiel@hamberger.de)